

# Lewis-Clark State Athletics



***2010-2011***

***Visiting Team Guide***

# Table of Contents

---

## Lewis-Clark State Athletic Department

Athletic Department Directory.....	2
Ticket Information.....	3
Facilities	
Activity Center.....	4
Harris Field.....	6
Baseball.....	9
Men’s and Women’s Basketball.....	10
Men’s and Women’s Golf.....	11
Tennis.....	12
Men’s and Women’s Cross Country / Women’s Track & Field.....	13
Volleyball.....	14
Food & Entertainment	
Restaurants.....	15
Entertainment.....	16
Travel & Lodging.....	17
Maps	
Map of Lewiston & Directions to the LCSC Campus.....	18
Map of LCSC Campus.....	19

# Athletic Directory

---

## ATHLETIC ADMINISTRATION

Gary Picone	Athletic Director	(208) 792-2863	gapicone@lcsc.edu
Brooke Cushman	Assistant Athletic Director	(208) 792-2675	blcushman@lcsc.edu
Julee King	Athletic Admin. Assistant	(208) 792-2471	jlking@lcsc.edu
Katie Savage	Athletic Admin. Assistant	(208) 792-2275	kesavage@lcsc.edu
Bert Sahlberg	Athletic Communications/SID	(208) 792-2200	bhsahlberg@lcsc.edu
Logan Fowler	Assistant SID	(208) 792-2289	ljfowler@lcsc.edu

## ACTIVITY CENTER/FACILITIES

Michael Benke	Director of Facilities & Ops	(208) 792-2366	mbbenke@lcsc.edu
---------------	------------------------------	----------------	------------------

## BASEBALL

Gary Picone	Head Coach	(208) 792-2863	gapicone@lcsc.edu
Gus Knickrehm	Assistant Coach	(208) 792-2171	gaknickrehm@lcsc.edu

## MEN'S BASKETBALL

Tim Walker	Head Coach	(208) 792-2865	tdwalker@lcsc.edu
Austin Johnson	Assistant Coach	(208) 792-2271	abjohnson@lcsc.edu

## WOMEN'S BASKETBALL

Brian Orr	Head Coach	(208) 792-2274	rborr@lcsc.edu
Janeen Nelson	Assistant Coach	(208) 792-2155	jnelson@lcsc.edu

## MEN'S & WOMEN'S CROSS COUNTRY/ WOMEN'S TRACK & FIELD

Mike Collins	Head Coach	(208) 792-2308	mcollins@lcsc.edu
--------------	------------	----------------	-------------------

## MEN'S & WOMEN'S GOLF

Paul Thompson	Head Coach	(509) 751-7366	pethompson@lcsc.edu
Cliff Carrick	Assistant Coach		

## MEN'S & WOMEN'S TENNIS

Kai Fong	Head Coach	(208) 792-2309	kfong@lcsc.edu
----------	------------	----------------	----------------

## WOMEN'S VOLLEYBALL

Jennifer Greeny	Head Coach	(208) 792-2258	jagreeny@lcsc.edu
Burdette Greeny	Assistant Coach	(208) 792-2258	bogreeny@lcsc.edu
Amy Kronemann	Assistant Coach	(208) 792-2258	

## ATHLETIC TRAINER

Tracy Collins	Trainer	(208) 792-2000	tcollins@lcsc.edu
---------------	---------	----------------	-------------------

# **Ticket Information**

---

## **Season Ticket Prices**

### **VOLLEYBALL SEASON PASS**

Individual-\$25

Senior-\$15

Family- \$50 (admits 2 adults and 3 youth)

### **MEN'S & WOMEN'S BASKETBALL- GA SEASON PASS**

Individual-\$50

Senior-\$35

Family- \$75 (admits 2 adults and 3 youth)

### **RESERVED SEASON TICKET--BASKETBALL ONLY**

\$75.00 –PER SEAT

### **BASEBALL SEASON PASS**

Individual-\$40

Senior-\$30

Family- \$50 (admits 2 adults and 3 youth)

### **ALL-SPORT- GENERAL ADMISSION**

Individual-\$100

Senior-\$75

Family- \$150 (admits 2 adults and 3 youth)

### **PER EVENT- GA SEATING**

Adult-\$5

Senior-\$3

JH/SH w/ID-\$3

6-12yrs-\$2

5 & Under-FREE

### **JR. WARRIOR CLUB**

*\$25- ALL SPORT PASS + 1 ADULT*

### **Students, Faculty and Staff Admissions Policy**

Current identification card mandated for admittance into Warrior athletics for the following:

Student– Allows one admission into regular season lsc athletic events.

Faculty/Staff– Allows admission into regular season lsc athletic events for the individual Faculty/Staff with spouse and kids. All must be present at the time of entry with ID card.

**Ticket sales - 208-792-2471**

---

Lewis-Clark State Warriors

# The Activity Center

Officially Opened in January of 2005, the Activity Center adds to the region's excellence in sports venues, and offers the Lewis-Clark valley the opportunity to experience Warrior sports in a more exciting and comfortable atmosphere. The facility includes three full size basketball courts, and seating for over 3,500. The tri-level, 100,000 square foot facility includes classrooms, dance and exercise studios, study areas, athletic trainers' facilities, offices, and many other multi-purpose areas. The 15 million dollar Activity Center has quickly become the centerpiece of a growing Lewis-Clark State College.



Activity Center's front gate



A view from east side of the court

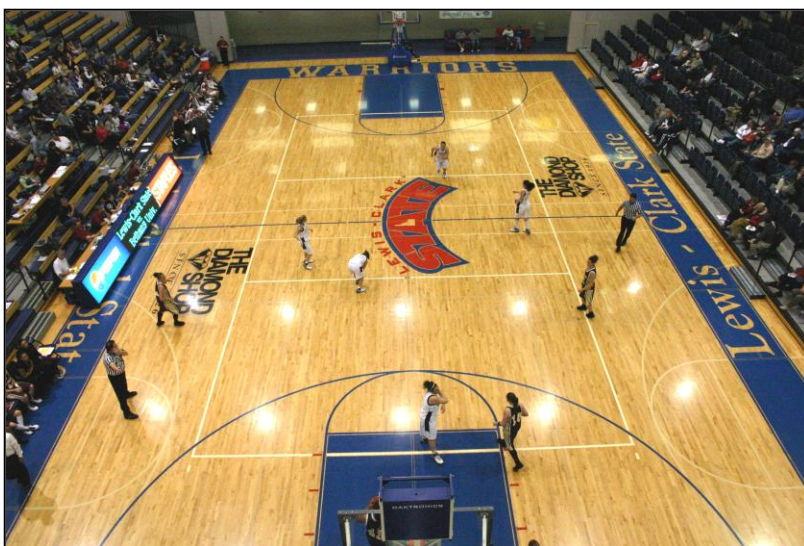

A look at the court from the Activity Center Suites

**Directions:** Located at the center of the college campus on the east side, the Activity Center's main doors stand at the corner of 6<sup>th</sup> Street and 9<sup>th</sup> Avenue directly adjacent to Harris Field in Lewiston. Team vehicles are welcome to unload at the front gate, but are asked to park at the parking lot located on the corner of 6<sup>th</sup> Street and 12<sup>th</sup> Avenue just south of Harris Field and the Activity Center. See pages 18 and 19 for directions and maps.

**Entrance:** Teams are instructed to enter the Activity Center via the tunnel-like unloading zone on the northeast side of the building (see diagram on pg. 5). The entrance at the bottom of this zone opens directly up to the main court. At the door, facility personnel will direct teams to their respective locker rooms. Direct all entrance and facility questions or concerns to:  
Michael Benke  
Dir. of Facilities & Ops  
Phone: 208-792-2366  
Cell: 208-790-0278  
Email: [mbbenke@lsc.edu](mailto:mbbenke@lsc.edu)

# The Activity Center

Activity Center Basement

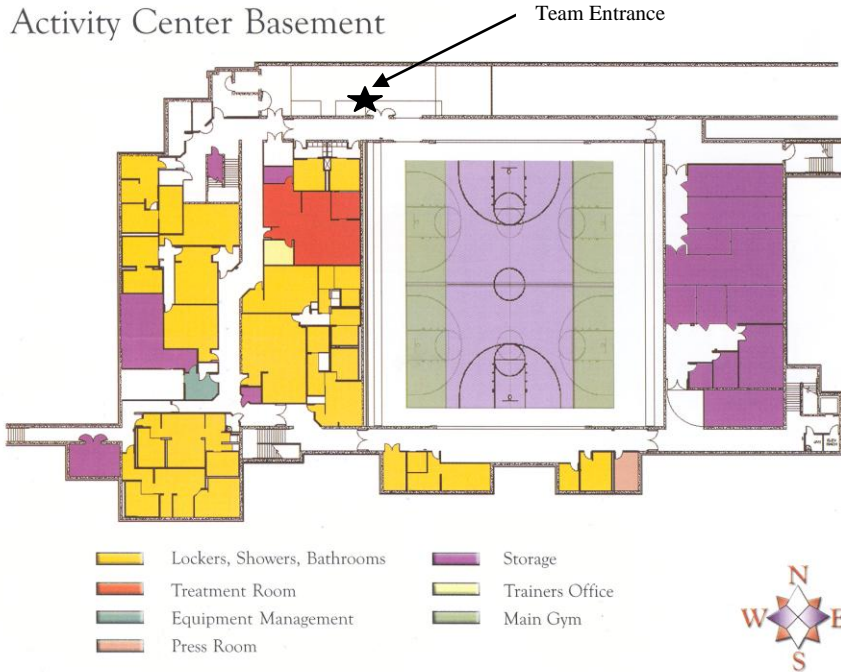

**Facility Information:**  
 Contact the Director of Facilities & Operations at: 208-792-2366 for information on locations and logistics.

## Athletic Training and Medical Services:

The treatment or trainer's room is also located on the basement level, and is room number 35 (see map above). If there are any special needs for your athletes please let us know so we can make the necessary arrangements. The training room is fully equipped with all necessary equipment.

## Athletic Trainer:

A trainer will be on hand at all athletic events. Phone: (208) 792-2000.

Activity Center Main Floor

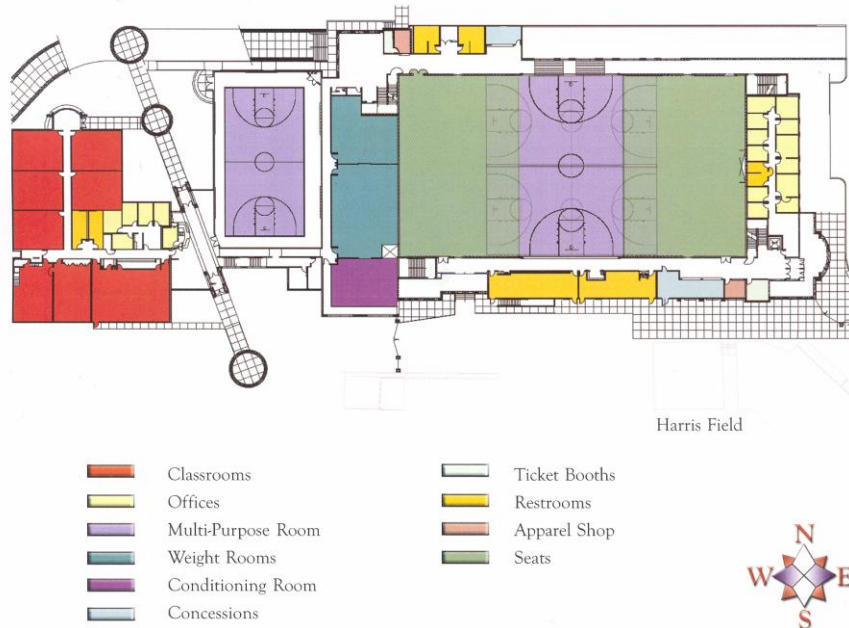

# Harris Field

---

Harris Field has been home to one of the most accomplished collegiate teams in the history of baseball, and to some of the most memorable moments in the history of the NAIA World Series. After years of baseball being played in cow pastures and back yards, Harris Field, slowly evolving and improving through the efforts of players, coaches, and volunteers, began to take its current shape in the 1970s. It was named after a prominent Lewiston business man and baseball enthusiast of the 1930s, Loyd Harris. Harris, known as “Mr. Baseball”, is one of the main reasons Lewiston has become the baseball town that it is today.

Although it has an official seating capacity of only 5,000, Harris Field has seen crowds exceed this total on multiple occasions. In 2008, the 52<sup>nd</sup> annual NAIA World Series brought a record crowd of 5,530 to Harris Field to watch the Warriors defeat Lee University 5-1 and win their 16<sup>th</sup> national title.

An experienced grounds crew and game management staff help keep Harris looking good all year round. From the rainy spring games in February to the beautiful NAIA World Series games in late May, Harris Field and the easygoing small town atmosphere of the Lewis-Clark valley give baseball fans a pleasant and memorable experience.



A look at Harris Field from the air.



**Directions:** Directly adjacent to the Activity Center, Harris Field sits on the corner of 6<sup>th</sup> Street and 11<sup>th</sup> Avenue, and official address is 500 8<sup>th</sup> Avenue. Teams are suggested to unload at the front gate located next to the Activity Center’s front doors and marked by an overhanging Harris Field banner.

**Bus Parking:** Team vehicles are welcome to unload at the front gate, but are ask to park at the parking lot located on the corner of 6<sup>th</sup> Street and 12<sup>th</sup> Avenue just south of Harris Field and the Activity Center. See pages 18 and 19 for directions and maps.

# Harris Field

**The Field:** Harris Field presents a standard dirt and grass field, with a grass outfield and wooden homerun fence. As a standard, the visiting team will be designated the first base dugout.

**Field Dimensions:**

Left Field Lane: 335 ft.  
Left Field Alley: 364 ft.  
Center Field: 372 ft.  
Right Center Field: 350 ft.  
Right Field: 335 ft.

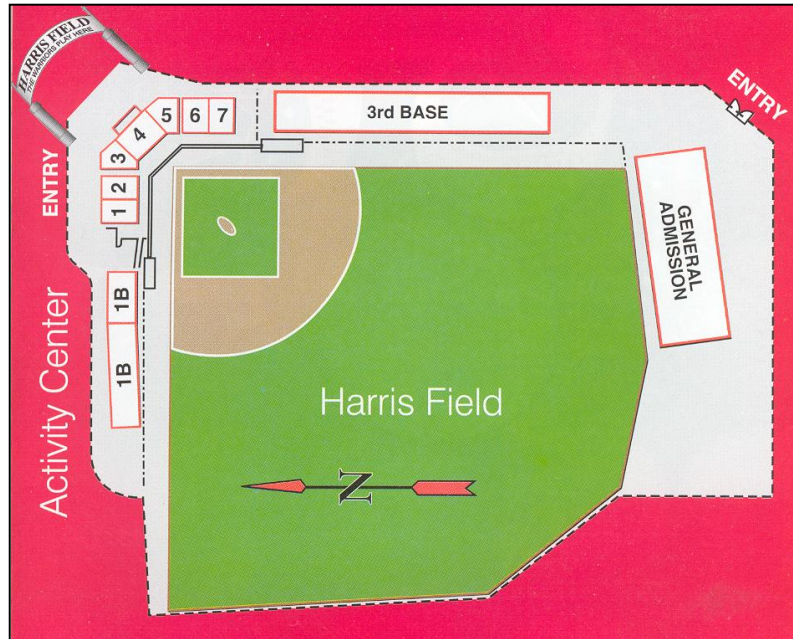

**Crowd Seating:** During the regular season every seat in the house is at general admission price. However, during the NAIA World Series there are reserved seating sections.

**Locker Room Assignments:** Visiting teams will be shown their locker rooms upon arrival to Harris Field. Locker rooms are located on the basement level of the Activity Center. See diagram on page 5 for details.

**Facility Information:** Contact the Director of Facilities & Operations at: 208-792-2366 for information on locations and logistics.

**Harris Field Ground Rules:**

1. A thrown ball can get lodged in or behind the padding behind home plate. If this occurs the ball is dead.
2. A thrown ball can rest on top of the padding behind home plate. The ball is live and in play. A batted ball that touches that touches the backstop netting is dead.
3. If a ball gets through the netting behind home plate the ball is dead.
4. The ball is dead if it gets through a gap at either end of the backstop netting by the support poles.
5. The support poles of the backstop netting near the camera wells are out of play. Any live ball that touches both net and support pole is immediately dead.
6. The camera wells at the home plate end of both dugouts are out of play. A demarcation line will define the out of play area. If a ball enters this area, the ball is dead.
7. The concrete floor of the dugout, across the entire width of the dugout (including the vertical wall at each end) are dead ball areas. The lip of the concrete floor and the top uppermost facing of the dugout roof are live. A ball that breaks the plane of the concrete lip is dead. (Continued on page 8)

# Harris Field

---

## Harris Field Ground Rules Continued:

8. All game personnel, with the exceptions of up to two (2) on deck batters, and all playing equipment must be kept inside the dugout at all times.
9. Electrical boxes/outlets on the ends of the dugouts are live.
10. The steel fence post and fencing along the ends of the dugouts are live.
11. All gates (at each end of the dugouts and down the right field line) must remain closed during play.
12. Any live ball that lodges in the banner affixed to the fences along each foul line will be ruled as a dead ball.
13. The tarp:
  - a. Live balls that go behind, into the tube, or break the demarcation line at either end of the tarp will be ruled as a dead ball
  - b. A player may not climb or stand on the tarp to extend the playing field. However, it is permissible to lean against the tarp: it is not permissible to stand on or kneel on the tarp to make a play happen.
14. Outfield fence:
  - a. Any fair-batted ball hit above the ten (10) foot outfield fence is immediately dead and ruled a double. Therefore, any bounding ball hitting the second row of signs above this fence, the scoreboard (including the protruding metal catwalk/stand); message center hitting eye in center field; etc. is a dead ball and ruled a double.
  - b. Please note there is not screen on the left field foul pole.
15. Any fair-batted ball or thrown ball that is:
  - a. Lodged in the shrubbery near the right field bullpen is dead.
  - b. Breaks the demarcation line in the opening of the fence down the right field line is dead.
  - c. Any live ball that hits the protruding grandstand in the right side foul territory is immediately dead.



Lewis-Clark State Warriors

# Warrior Baseball

---

Established in 1905, Warrior baseball has been Lewis-Clark State College's pride and joy over the years. With over 24 trips to the NAIA World Series and with 16 championships won from 1984-2008, the LCSC Warriors are recognized, not only by members of the NAIA but by baseball enthusiasts at all levels, as one of the premier programs in the country.

The Warriors play at Harris Field (see pages 8-10 for field information)

<b>Game Protocol</b>	
<b>Time</b>	<b>Activity</b>
25:00	Away team infield-outfield
15:00	Home team infield-outfield
5:00	Coaches and umpires meeting at home plate
0:00	Team Introductions
	1. Visiting team on the third baseline
	2. Home team on first baseline
	3. Officials behind home plate
	National Anthem
	Game Begins

**Crowd Seating:** During the regular season every seat in the house is at general admission price. However, during the NAIA World Series there are reserved seating sections.

**Locker Room Assignments:** Visiting teams will be shown their locker rooms upon arrival to Harris Field. Locker rooms are located on the basement level of the Activity Center. See map on page 6 for details.

**Facility Information:** Contact the Director of Facilities & Operations at: 208-792-2366 for information on locations and logistics.

**Team Practice Times:** For practice times and locations contact the Warrior's coaching staff. Names and numbers can be found at [www.lcsc.edu/athletics](http://www.lcsc.edu/athletics), or on page 2.

**Athletic Trainer:** A trainer will be on hand at all athletic events. Phone: (208) 792-2000.

**Bus Parking:** Team vehicles are welcome to unload at the front gate, but are ask to park at the parking lot located on the corner of 6<sup>th</sup> Street and 12<sup>th</sup> Avenue just south of Harris Field and the Activity Center. See pages 18 and 19 for directions and maps.

# Warrior Men's & Women's Basketball

---

LCSC Men's and Women's basketball has become two most successful programs in the Frontier Conference. Since 2000, both programs have won five conference championships. After a long history playing in the Warrior Gym, the Warriors out grew it and moved to their new 15 million dollar multi-purpose arena. In 2005, the Warriors played their first game in Activity Center.

For more information on the Activity Center see pages 4 and 5.

<b>Game Protocol</b>	
<b>Time</b>	<b>Activity</b>
60:00	Activity Center opens its doors/clock starts
20:00	Official warm-up begins
0:00	National Anthem
	Visiting team introductions
	Home team introductions
	Teams to benches for 60-second break
	Tip-off

**Locker Room Assignments:** Visiting teams will be shown their locker rooms upon arrival to the Activity Center. Locker rooms are located on the basement level of the Activity Center. See map on page 6 for details.

**Facility Information:** Contact the Director of Facilities & Operations at: 208-792-2366 for information on locations and logistics.

**Team Practice Times:** For practice times and locations contact the Warrior's coaching staff. Names and numbers can be found at [www.lcsc.edu/athletics](http://www.lcsc.edu/athletics), or on page 2.

**Athletic Training and Medical Services:** The treatment or trainer's room is also located on the basement level, and is room number 35 (see diagram on page 2). If there are any special needs for your athletes please let us know so we can make the necessary arrangements. The training room is fully equipped with all necessary equipment.

**Athletic Trainer:** A trainer will be on hand at all athletic events. Phone: (208) 792-2000.

**Bus Parking:** Teams are instructed to enter the Activity Center via the tunnel-like unloading zone on the northeast side of the building (see diagram on pg. 5), but are ask to park at the parking lot located on the corner of 6<sup>th</sup> Street and 12<sup>th</sup> Avenue just south of Harris Field and the Activity Center. See pages 18 and 19 for directions and maps.

# Warrior Men's and Women's Golf

---

Lewis-Clark State College's nationally ranked golf program has consistently established competitive teams since its formation in 1999. The players are fortunate in that they have the opportunity to practice and play on four different golf courses year-round in the Lewis-Clark valley. Such golf courses include, Bryden Canyon, Quail Ridge, and the Lewiston and Clarkston Country Clubs.



[www.cityoflewiston.org/parkrec/bryden\\_canyon.htm](http://www.cityoflewiston.org/parkrec/bryden_canyon.htm)  
445 O' Connor Road  
Lewiston, ID 83501  
(208) 746-0863



[www.golfquailridge.com](http://www.golfquailridge.com)  
3600 Swallow's Nest Drive  
Clarkston, WA 99403  
(509) 758-8501

**Lewiston Golf and Country Club**  
395 Country Club Drive  
Lewiston, ID 83501  
(208) 743-3549 or (208) 746-2801

**Clarkston Golf and Country Club**  
Clarkston, WA 99403  
(509) 758-2546 or (509) 758-7911



# Warrior Tennis

---

Tennis has been a part of Lewis-Clark State College since as early as 1910, Warrior tennis as a collegiate program did not take shape until the late 1970s. Today the program stands as one of the best in the NAIA, and holds an impressive number of both regional and national titles.

**Tennis Center:** The nationally ranked program plays on one of the finest player's courts in the northwest. Built in 1975, Lewis-Clark State College's Tennis Center is a four-court indoor facility that within the last six years has undergone immense upgrading and remodeling. Improvements include an extensive resurfacing, a new roof, and an upgraded lighting system. Because of location and the facilities quality, the Tennis Center hosts a number of collegiate events including matches featuring prominent NCAA Division I programs. The Tennis Center and LCSC program serves both the community and the collegiate northwest year-round, and draws players from all around the world.



One of four courts in Tennis Center

**Directions:** The Tennis Center is located on the LCSC campus just west of Harris Field. See map on page 19 for details.

**Team Practice Times:** For practice times and locations contact the Warrior's coaching staff. Names and numbers can be found at [www.lcsc.edu/athletics](http://www.lcsc.edu/athletics), or on page 2.

**Athletic Trainer:** A trainer will be available at all athletic events.



The Tennis Center being resurfaced

# Warrior Track & Field / Cross Country

---

Given the cold, wet climate of the northwest, the Lewis-Clark Valley offers ideal conditions for all outdoor sports. A couple of sports that definitely take advantage of the beautiful weather are cross country and track and field. Lewis-Clark State College has long been involved in these kinds of competitions, and today has established nationally ranked women's and men's programs. Unlike the cross country program, which has been active and going strong for years, the track team enjoyed a short stint in the 1960s, but then dissolved and did not reappear again until 1998. Both programs are growing into two of the most competitive ones in the NAIA.



Running the hills during the LCSC Invitational

**For Information:** Contact the cross country/track and field coaching staff for all questions. Staff and other relative information can be found at [www.lcsc.edu/athletics](http://www.lcsc.edu/athletics).

**Athletic Trainer:** A trainer and medical personnel will be available at all athletic events.

**Where They Run:** The Warrior cross country team run and practice at various locations in the Lewis-Clark Valley. Such locations include the Lewiston grade and other surrounding hilly areas, and the run along the picturesque Snake River. The perfect climate and memorable scenery make the L-C Valley the perfect place to run.



A home meet with the beautiful L-C Valley in the background

# Warrior Volleyball

---

The Lewis-Clark State volleyball program, which has won four conference championships since 1999 including one 2007 when it also won the regional championship, plays its matches inside the Activity Center. The Activity Center's arena serves as one of the best volleyball venues in the Frontier Conference and because of its dual-court capability it can host tournaments with ease.

For more information on the Activity Center see pages 4 and 5.

<b>Game Protocol</b>	
<b>Time</b>	<b>Activity</b>
60:00	Home team full court
50:00	Visiting team full court
40:00	Shared court
19:00	Visiting team full court—serve/receive
15:00	Home team full court—serve/receive
11:00	Visiting team full court—hit/receive
6:00	Home team full court—hit/receive
0:00	Team huddle
	National Anthem

**Locker Room Assignments:** Visiting teams will be shown their locker rooms upon arrival to the Activity Center. Locker rooms are located on the basement level of the Activity Center. See map on page 6 for details.

**Facility Information:** Contact the Director of Facilities & Operations at: 208-792-2366 for information on locations and logistics.

**Team Practice Times:** For practice times and locations contact the Warrior's coaching staff. Names and numbers can be found at [www.lcsc.edu/athletics](http://www.lcsc.edu/athletics), or on page 2.

**Athletic Training and Medical Services:** The treatment or trainer's room is also located on the basement level, and is room number 35 (see map above). If there are any special needs for your athletes please let us know so we can make the necessary arrangements. The training room is fully equipped with all the necessary equipment.

**Athletic Trainer:** A trainer will be on hand at all athletic events. Phone: (208) 792-2000.

**Bus Parking:** Teams are instructed to enter the Activity Center via the tunnel-like unloading zone on the northeast side of the building (see diagram on pg. 5), but are ask to park at the parking lot located on the corner of 6<sup>th</sup> Street and 12<sup>th</sup> Avenue just south of Harris Field and the Activity Center. See pages 18 and 19 for directions and maps.

# Restaurants

---

**El Sombrero**

625 Main St.  
Lewiston, ID 83501  
(208)746-2440

**Applebee's**

2235 Thain Grade  
Lewiston, ID 83501  
(208) 746-8000

**McDonald's**

711 21<sup>st</sup> Street  
Lewiston, ID 83501  
(208) 743-8181

**Waffles N' More**

1421 Main Street  
Lewiston, ID 83501  
(208) 743-5189

**Tomato Bros**

200 Bridge St.  
Clarkston, WA 99403  
(208) 758-7902

**Roosters**

1550 Port Dr.  
Clarkston, WA 99403  
(509) 751-0155

**Southway Pizzeria & Deli**

721 – 16<sup>th</sup> Avenue  
Lewiston, ID 83501  
(208) 743-0400

**Main Street Grill**

2214 E. Main  
Lewiston, ID 83501  
(208) 746-1205

**Red Lobster**

2115 Thain Grade  
Lewiston, ID 83501  
(208) 746-9096

**Rusty's Steakhouse**

2418 N & S Hwy  
Lewiston, ID 83501  
(208) 746-5054

**Zany's Hollywood Grill**

21<sup>st</sup> St. & 19<sup>th</sup> Ave.  
Lewiston, ID 83501  
(208) 746-8131

**Taco Time**

1828 21<sup>st</sup>  
Lewiston, ID 83501  
(208) 746-1961

**Arby's**

721 21<sup>st</sup>.  
Lewiston, ID 83501  
(208) 746-7227

# Entertainment

---

## **Village Centre Cinemas**

2920 Nez Perce Dr.  
Lewiston, ID 83501  
(208) 798-8080

## **Lancer Lanes**

1250 Bridge St.  
Clarkston, WA 99403  
(509) 758-6731

## **Lewiston Shopping Mall**

1810 19th Avenue  
Lewiston, ID 83501  
800-419-8663

## **Orchards Lanes**

244 Thain Rd.  
Lewiston, ID 83501  
(208) 743-7822

For a current list of activities in the valley and surrounding area visit the Lewiston Chamber of Commerce Valley & Regional Events Calendar at:  
[www.lewistonchamber.org/calendar\\_main.htm](http://www.lewistonchamber.org/calendar_main.htm).

# Travel & Lodging

---



**RED LION**  
HOTEL  
LEWISTON  
621 21st street  
Lewiston, ID 83501  
(208) 799-1000



**GuestHouse International Inn & Suites**  
1325 Main Street  
Lewiston, ID 83501  
Voice: (208) 746-3311 Fax: (208) 746-7955



**Comfort Inn**  
2128 8th Ave  
Lewiston, ID 83501  
208-798-8090 or 1-800-228-5150



**Holiday Inn Express**  
2425 Nez Perce  
Lewiston, ID 83501  
(208) 750-1600  
fax (208) 750-1800



**Clearwater River**  
CASINO & RESORT  
Clearwater River Casino & Resort  
17500 Nez Perce Rd.  
Lewiston, ID 83501  
208-298-1400



**Quality Inn & Suites**  
700 Port Dr.  
Clarkston, WA  
(509) 758-9500



**Inn America**  
702 21st Street  
Lewiston, ID 83501  
208-746-4600



**Best Western**  
1257 Bridge St.  
Clarkston, WA  
(509) 758-9551 or 1-800-325-8765

# Map of Lewiston & Driving Directions

## Driving Directions to LCSC

### **From the west on US Highway 12 (Walla Walla, Tri-Cities, etc.)**

You need to be in the right lane as you cross the Interstate Bridge over the Snake River from Clarkston to Lewiston.

Take a sharp right off the bridge. This is Snake River Avenue.

Continue for 0.8 Miles. Turn left on 11th Avenue.

Turn left on 6th street. You will see the baseball field.

Go straight until you see the parking lots on your right.

### **From the North/Northwest on US Highway 95/195 (Moscow, Pullman, etc.)**

US Highway 195 goes south from Spokane, WA through Colfax and Pullman, WA. US Highway 95 goes south from Coeur d'Alene, ID through Moscow. Highway 195 becomes Highway 95 approximately 6 miles north of Lewiston, ID.

Proceed south on US Highway 95 into Lewiston, staying to your right at the bottom of the hill and merging on US Highway 12 West into Lewiston, crossing the Clearwater River on Memorial Bridge.

Just past the bridge, US Highway 12 will turn to the right. Stay in the left lane, and take a left turn at the light onto 21st Street/Thain Road.

Proceed south on 21st Street/Thain Road until you come to 11th Avenue.

Turn right on 11th Avenue, and proceed on 11th Avenue until you come to the intersection of 11th Avenue and 6th Street.

You are now at Lewis-Clark State College's southeast corner.

### **From the South/East on US Highway 95 (Boise & Grangeville) and US Highway 12 (Orofino & Missoula, MT)**

You need to be in the left lane as you cross the Memorial Bridge over the Clearwater River into Lewiston.

Go through the first light you encounter. You should be on 21st Street.

Turn right onto 11th Avenue. Albertsons Grocery Store will be on your right at this intersection.

Follow until 6th street and take a right. You will see the baseball field.

There will be parking lots on your right and the campus will be on your left.



Map Copyright © 2001 Qwest (www.Dexonline.com)

### **From Lewiston Nez Perce County Airport**

Leaving the Parking Lot of the airport, turn left onto Bryden Canyon Road.

At the first major intersection, take the exit to your right onto 8<sup>th</sup> Street from Bryden Canyon Road.

Turn right on 8<sup>th</sup> Street, and follow 8<sup>th</sup> Street all the way until you come to 11<sup>th</sup> Avenue.

Turn left on 11<sup>th</sup> Avenue, and proceed 2 blocks to 6<sup>th</sup> Street.

You are now at Lewis-Clark State College's southeast corner. The main college is bordered by 7<sup>th</sup> Avenue on the North, 12<sup>th</sup> Avenue on the South, 4<sup>th</sup> Street on the West, and 6<sup>th</sup> Street on the East.

# LCSC Campus Map

## LEWIS-CLARK STATE COLLEGE

Lewiston, Idaho

