

THE RIVER REVIEW

OCTOBER 2006

Inside this issue:

2006 ASLCSC CDA Reps. 2

Student Activity for October 3

Contact ASLCSC CDA 3

Calendar of Events 4

LCSC Continues to Grow 4

If you have any news that you would like to see appear in the November issue of the River Review please contact Jeff Wilson at jjwilson@lcwarriormail.com

Coeur d'Alene Lewis-Clark State College Newsletter |

Associated Students of LCSC Coeur d'Alene

The student government at LCSC-CDA is made up of one representative from each major offered. Kate Bales, our Chairperson, represents the Communications majors; Janiece Skranak, our Vice-Chairperson, is representing the Criminal Justice majors; Jacqueline Maurer, our Secretary/Treasurer, is representing the Social Work majors; Jeff Wilson, who is organizing the Media/PR aspect of the student govt. represents the Business division, Serena Worobel

who is organizing the student activities aspect of the student government represents the Interdisciplinary majors; and Teresa Floyd represents the Nursing majors.

These students are working for the student body. Their goal is to address the issues that are important to the students enrolled at LCSC-CDA. All students are encouraged to share any concerns or recommendations with their representative. As students

themselves, the committee is focused on serving the current student body as well as improving the institution for future Warriors

Learn more about your ASLCSC Coeur d'Alene student representatives on pg. 2.

E-mail your student council at:
cdastudents@lsc.edu

U.S. NEWS & WORLD REPORT GIVES LCSC A NO. 1 RANKING

According to U.S. News & World Report, Lewis-Clark State College is again No. 1.

For the third time in 6 years, the national magazine's annual ranking of "America's Best Colleges" has selected the Lewiston, Idaho college as the top comprehensive bachelor's degree offering public college in the West.

The rankings, which came out in September, mark the 6th straight year LCSC has been ranked 3rd or higher in the West. LCSC also was ranked No. 1 in the West in 2001 and 2004, and was tied for second last year. The college also was ranked 3rd in 2002 and 2003.

The magazine ranks more than 1,400 colleges and universities across the U.S. The comprehensive college rankings

are for public colleges that focus on undergraduate education and offer degree programs ranging from liberal arts to professional fields. The criteria used in ranking the schools include the school's academic reputation, retention and graduation rates, average size of classes, percentage of faculty who are full time, student/faculty ratios, and alumni giving rates.

LCSC President Dene K. Thomas says the honor proves the important role LCSC plays in the community.

"This is a great honor because it validates the quality education that we offer our students," Thomas says. "We're proud to say the we offer a private school experience at public school cost, with small classes and personal attention from faculty."

Thomas says LCSC has a friendly, supportive environment where students can thrive because of support in several areas. Students take classes from professors, not graduate assistants, and receive one-on-one personal attention. Thomas adds the campus has numerous programs that provide extra academic assistance.

LCSC drew high marks for student-to-faculty ratio in classes and the percentage of faculty who are full time.

"We are elated," Thomas said. "We know we have a quality school here and we are a good value for a student's education dollar. We provide a quality education and remain a low-cost institution."

Courtesy of College Communications

Meet Your 2006-2007 ASLCSC-CDA Representatives



Kate Bales Communication Arts **Chairman** kmbales@lcwarriormail.com

I was born in Iowa, and I moved here in May of 2001. I love many things about North Idaho, including Lake Coeur d'Alene, huckleberries and riding my bike on the Centennial Trail. I graduated last year from NIC with my Associate's degree, and I bring along with me the experience of being president of two student clubs, and an active member of two more. I also worked closely with ASNIC, and I often could be found at the monthly Board of Trustees meetings. You could say that I'm a bit of an activist! I am looking forward to representing my division and all the students of LCSC Coeur d'Alene.



Janiece Skranak Justice Studies **Vice-Chairman** jmskranak@lcwarriormail.com

I graduated NIC, and hope to graduate from LCSC this coming spring. I enjoy reading, my family and pets. I am beginning to believe that I am a workaholic, as I attend school full time, am doing my internship, and have two part time jobs. When I graduate I hope to work for the Department of Corrections.



Jacquelin Maurer Social Work **Secretary/Treasurer** jmaurer@lcwarriormail.com

I was raised in North Idaho and joined the Navy after High School. I finally got the chance to attend college after my son was born. I graduated from NIC in the Spring of 2005 and will graduate from LCSC in 2007. I am a social work major and my passion is working with at-risk-youth. I am doing my internship at Juvenile Diversion and love it! I am very involved with the SOSW (Student Organization of Social Workers) and I volunteer for the Juvenile Probation Department. I have been an officer for two different clubs for three years now and look forward to serving the students of LCSC-CDA this year.



Jeff Wilson Business Administration **Media/PR Chair** jjwilson@lcwarriormail.com

As a lifetime resident of the Coeur d'Alene/Hayden Lake area I consider it a great privilege to be able to attend a quality school like LCSC in a setting that is truly unbeatable. I am entering my final year at Lewis-Clark State College CDA, culminating in a Bachelor of Science in Business Administration with emphasis in Accounting this coming spring. Beyond that I plan on becoming a Certified Public Accountant and entering an MBA program at either Gonzaga University or The University of Montana. When I am not attending class or studying, I can usually be found on one of the many trout streams here in the Inland Northwest and British Columbia. The last 8 summers I have found myself working as a Fly Fishing Guide in both North Idaho and Western Montana, a job that will certainly be difficult to give up following graduation. I look forward to representing the Business Division within ASLCSC CDA and to serving in the interest of our fantastic exceptional student body!



Serena Worobel Interdisciplinary Studies **Activities Chair** sjworobel@lcwarriormail.com

When I moved to Coeur d'Alene from Chicago 3 years ago, I wanted to go on a "permanent vacation", as this place is gorgeous, wonderful, and absolutely amazing to me. But, after just a bit away from school, I realized I missed, and joined back up. This will be my second year at LCSC CDA, working towards my BS. I still have no clue what profession I will pursue once I achieve my agree, since I really do love my current job as the Senior Course Engineer & Video Producer for a CDA based company that does nation wide computer-based law enforcement and commercial training. In my spare time, when I have it, I am (secretly) a huge computer nerd, and spend my time working on HTML and Gentoo Linux. I also enjoy music and concerts, and (as I mention...) just about everything about Coeur d'Alene! Although I have never held a student representative position, I am looking forward to working together with the other great members of ASLCSC, and hope that we can make this a great year for everyone!

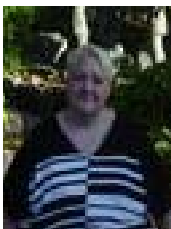

Teresa Floyd Nursing **At Large** tasena@adelphia.net

Hello everyone! I was born in Coeur d'Alene and plan to be here for the rest of my life. I have been a nurse for 15 years and am in the RN to BSN program. When I have completed my BSN I plan to go on for a dual masters. I have a 17 year old son. I am the representative for the nursing students in CDA and I am looking forward to working with all of you!

Student Activity for October: The Amazing Corn Maze

Saturday, October 28 at 6 p.m. ASLCSC Coeur d'Alene will be hosting the first student activity of the school year. The cost is \$8 for adults and \$5 for children 5-12 years of age, children younger than 5 get in free. Transportation is available by contacting Jeff Wilson @ 208-964-0283, or emailing cdastudents@lcsc.edu. Come enjoy a fun filled evening and get to know your fellow students!

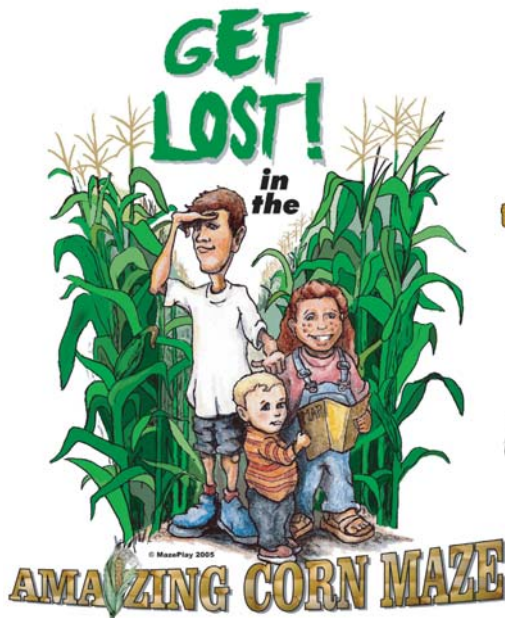

Just south of Hwy 53 on Prairie Rd. in Hauser, Idaho

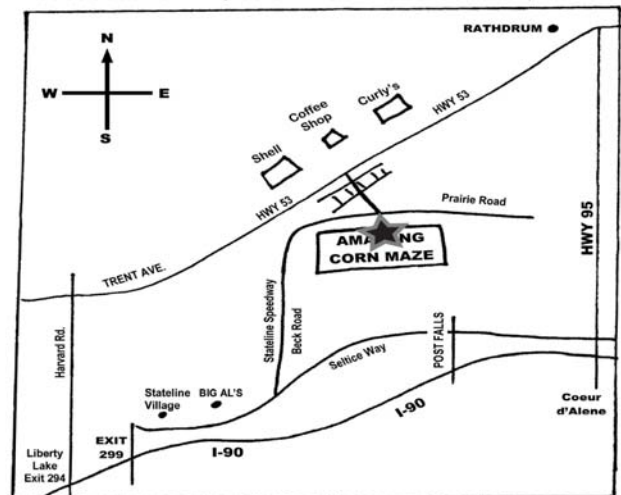

Student Council Wants to Hear From You!

The student council at LCSC-CDA is comprised students working for students. One of our primary goals is to address the current issues that the student body feels are important. The key to our success is feedback and open lines of communication with the student body. This is why your committee has created its own e-mail address to communicate any questions or concerns that you may have.

Additionally, each representative has their own address to communicate those issues that may deal with specific majors within our institution.

Student Council:
cdastudents@lcsc.edu

Communication Arts:
kmbales@lcwarriormail.com

Justice studies:
jmskranak@lcwarriormail.com

Social Work:
jmaurer@lcwarriormail.com

Business Administration:
jjwilson@lcwarriormail.com

Interdisciplinary Studies:
sjworobel@lcwarriormail.com

Nursing:
tasena@adelphia.net



October 2006

Sun	Mon	Tue	Wed	Thu	Fri	Sat
1 <i>World Vegetarian Day</i>	2 <i>Yom Kippur</i>	3 <i>Captain Kangaroo Day</i>	4 <i>National Golf Day</i>	5 <i>Ray Kroc (McDonald's) Born 1902</i>	6 <i>First Motion Picture 1889</i>	7 <i>World Habitat Day</i>
8 <i>Inventor of the automobile born 1869</i>	9 <i>Columbus Day</i>	10 <i>Pac-Man released in Japan 1979</i>	11 <i>Eleanor Roosevelt born 1884</i>	12 <i>Farmer's Day</i>	13 <i>Margaret Thatcher born 1925</i>	14 <i>Winnie-the-Pooh published 1926</i>
15 <i>National Grouch Day</i>	16 <i>World Food Day</i>	17 <i>Black Poetry Day</i>	18 <i>Puerto Rico became US colony 1898</i>	19 <i>National Anthem first sung 1814</i>	20 <i>Tom Petty born 1950</i>	21 <i>Guggenheim Museum opened 1959</i>
22 <i>National Nut Day</i>	23 <i>Edison Pele (soccer) born 1940</i>	24 <i>United Nations Day</i>	25 <i>National Denim Day</i>	26 <i>Red Cross organized 1863</i>	27 <i>Theodore Roosevelt born 1858</i>	28 <i>Amazing corn maze 6 p.m.</i>
29 <i>Daylight savings ends</i>	30 <i>John Adams born 1735</i>	31 <i>Happy Halloween</i>				

Upcoming Events

- **October 2**— Graduation applications due for 2007 Grads
- **October 5**— ASLSCC-CDA meeting in Lewiston with ASLSCC
- **October 20**— Mid Term Grades due
- **October 28**— First Student Activity of the year! 6 p.m. at the amazing corn maze. See pg. 3
- **October 31**— **HAPPY HALLOWEEN!**... yes classes will be in session
- **November 3**— Last day to withdraw from classes
- **November 6-9**— Advanced registration for Spring 2007 opens for currently enrolled students only

* If there are events that you would like to see posted on the November calendar please contact Jeff Wilson at jjwilson@lcwarriormail.com

LCSC Continues to Grow: 10th Day Numbers Announced

Lewis-Clark State College continues to show impressive growth in the number of freshmen enrolling straight out of high school and with minority students as both areas had significant increases from a year ago, according to the college's 10th day report for the 2006 fall semester.

LCSC's direct-from-high school enrollment rose 8 percent from a year ago.

All state schools are required to file 10th-day reports to the State Board of Education. All school enrollment figures are based on the numbers on the 10th day of school. The 10th day of classes at LCSC this fall was Monday, Sept. 11.

The increase in high school enrollment continues a trend in more traditional students attending LCSC. In 2001, LCSC has 1,696 students who were age 25 and younger. This fall, that number is 2,206.

LCSC President Dene K. Thomas and Dean of Student Service Andy Hanson both credit the college's new student residence halls for helping attract younger students, which has been a key to the college's growth in Thomas' tenure because non-traditional student numbers have remained steady.

"We have a lot of reasons to be proud of

the job we're doing," Thomas says. "We have a wonderful faculty and staff, and it shows in the quality of our product. Our students know that."

LCSC also had a 4.5 percent increase in its minority student population. LCSC has 375 students who claim minority status, which represents 11 percent of the total student body population.

The increase in minority students is in part because of a 14.8 percent increase in international students compared to a year ago. LCSC has 132 international students on campus this fall.

The LCSC-Coeur d'Alene campus continues to be popular as it enjoys its 6th straight semester of more than 300 students and its total of 358 student is double of what it was 6 years ago.

The overall headcount for the 2006 fall semester is 3,394 students, which is a whopping 25.6 percent increase in enrollment from 6 years ago. LCSC's enrollment was 2,702 for the 2000 fall semester when Thomas became president of the college.

The overall headcount is down just a bit from last fall's enrollment of 3,451 students.

Among the more interesting enrollment

Figures at LCSC is the number of students majoring in Business continues to climb at an impressive rate, jumping 17 percent from a year ago. One misleading statistic with majors is that the Social Science Division increased declared majors by 28 percent while the Education Division went down 23 percent. Those figures, however, are because of the move of Psychology program from the Education Division to Social Sciences during the summer. The Natural Sciences Division had an 11 percent increase in declared majors from a year ago.

With the change in the Psychology program, the Business Division has the most students at 505, while Education is now second at 471. The Social Science Division, with 101 Psychology majors, is third at 444, one student ahead of Nursing & Health Sciences Division.

LCSC's student population continues to be heavily female oriented. There are 2,106 females at LCSC this fall, compared to 1,288 males.

Of the total student population, 1,214 are freshmen, 634 are sophomores, 639 are juniors, and 898 seniors.